



Which Hitch?

Hornet ATV/UTV Specialty Receiver Hitches

Intrinsic Minds, LLC (branded Hornet Outdoors) manufactures receiver hitch products for the ATV/UTV market as well as the Auto/Truck market. Hitches manufactured by Intrinsic ALL solve problems and improve functionality that other hitch manufacturers do not address. Many/most are patent pending and all are Made in USA at this time which allows for more reliable delivery of products as compared to products manufactured in China. Hitch products are all made in Minnesota and Colorado.

Background

All autos and trucks (pickups) have a receiver that terminates nearly flush with the back bumper. ATV/UTV receivers are dissimilar in that they terminate near the rear differential generally located forward of the rear bumper or bed requiring that the hitch be extended. Additionally, ATV/UTV receivers are lower, requiring that virtually all hitch applications be raised.

Another unique requirement of ATV/UTV's is that hitches are most often used for "non towing" applications such as spare tire carriers, hitch cargo carriers, feeders, spreaders, tool boxes, etc so it's necessary to be able to raise and extend the receiver, not simply provide an adjustable ball hitch.

Likewise, in the truck/auto market receiver hitches often have to be raised or lowered depending on the application. Autos and Vans receivers are low, making it difficult to attach cargo carriers, bicycle racks etc and lifted trucks require the receiver to be lowered.

Hornet Outdoors manufactures a wide variety of specialty hitches. This guide will provide you with a brief description of each.

[Click on any Title and we will take you directly to that page.](#)

Hitches and Hitch Products Designed for ATV/UTV Use

[U-6000-B ATV/UTV Hitch Cargo Carrier](#)

Designed specifically for the ATV/UTV Market the carrier features a more narrow stance to keep mud off the tires from landing on your gear.

All Steel Welded and Powder Coated. Comes with 2" straight receiver so you may want to add an adjustable hitch or curved riser to keep your load up off the ground.



U-4044 ATV/UTV Receiver Hitch Riser

Receiver Hitch Riser extends your ATV or UTV receiver hitch by 14" to clear the rear of the vehicle and raises it by 8" for compatibility with 2" receiver hitch accessories.



U-4054 Heavy Duty Truck or ATV/UTV Receiver Hitch Riser

Receiver Hitch Riser extends your ATV or UTV receiver hitch by 14" to clear the rear of the vehicle and raises it by 8" for compatibility with 2" receiver hitch accessories.



U-4043 ATV/UTV Adjustable Receiver Hitch

An Adjustable Receiver Hitch with an extended 2" female receiver hitch for standard 2" receiver hitch access. Adjusts vertically from a 12" to 20". Horizontal adjustment in 1.5" increments. Ideal of applications where you need an adjustable connecting point such as towing, feeders, spreaders and cultivators and you can also insert your ball hitch and use it for towing.



U-4044 2 ATV/UTV Receiver Hitch Riser/Converter

Designed specifically for the UTV Sport and ATV Market this receiver features a curved lower to negate ground hang-up, raises the hitch point and converts the 1 1/4" receiver to 2".

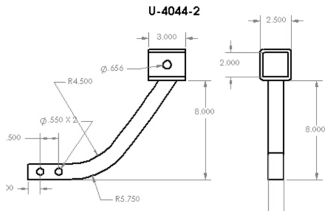

U-4044 FP ATV/UTV Receiver Hitch Riser and Towing Tongue

Features 1 1/4" Receiver Hitch, Curved Lower to negate ground hang-up and two holes on the Tow Plate; a 1/2" hole and 1" hole so it can be used to tow a Farm Cart or install a Ball Hitch.

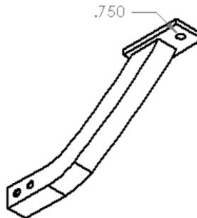

U-6043 1 1/4" Adjustable Receiver Hitch

This Adjustable Receiver Hitch is compatible with any standard 1-1/4" vehicle receiver hitch and all standard 2" receiver hitch accessories.



U-4044 FP B ATV/UTV Receiver Hitch Riser and Towing Tongue and 2" Ball.

Features 1 1/4" Receiver Hitch, Curved Lower to negate ground hang-up and Ball Hitch.

U-4052 ATV/UTV Dual "Piggyback" Hitch Extender Short

The upper 2" female receiver lets you use one of our Receiver Hitch Spare Tire Mounts while the lower 2" female receiver is available for towing or other use.



U-4051 ATV/UTV Hitch Extender Short

The Hitch Extender provides 4-1/2" of extension if you have a receiver hitch mounted accessory that doesn't quite clear the rear of your vehicle. Works best on UTV's with a forward receiver such as Polaris Ranger, Can Am Defender and Yamaha Viking.



U-4053 ATV/UTV 1 1/4" to 2" Hitch Adapter

This Hornet Outdoors Receiver Hitch Adapter was designed specifically for ATV/UTV use and is extremely short - it extends the hitch just 4-1/2".



U-4200 Heavy Duty Adjustable Receiver Hitch

The popular U-4200 Adjustable Receiver Hitch is a heavy duty version of our U-4043 ATV/UTV Adjustable Receiver Hitch Designed for on highway use SUVs and trucks with 5,000 pound towing and 500 pound tongue weight capacity. The Adjustable Receiver Hitch can be installed to raise the receiver hitch 3" to 9" for vehicles with low hitches or to lower the receiver hitch 3" to 9" for lifted vehicles or other vehicles with high hitches. Also extends receiver hitch 3" to 9" towards rear of vehicle. Like the U-4043 can be inverted to lower the hitch towing point as well.



U-5200 Curved Heavy Duty Adjustable Receiver Hitch

The popular U-5200 Adjustable Receiver Hitch is a curved our U-4200 Adjustable Receiver Hitch Designed for on highway use SUVs and trucks with 5,000 pound towing and 500 pound tongue weight capacity. The Adjustable Receiver Hitch can be installed to raise the receiver hitch 3" to 9" for vehicles with low hitches or to lower the receiver hitch 3" to 9" for lifted vehicles or other vehicles with high hitches. Also extends receiver hitch 3" to 9" towards rear of vehicle. Like the U-4043 can be inverted to lower the hitch towing point as well.

